

RCCN 日成BGQ1防水型快速软管接头 Quick Conduit Connector

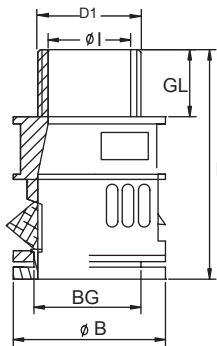

螺纹规格:公制螺纹(Metric)/德制螺纹(PG)/英制螺纹(G)
 产品材质:尼龙66(NYLON66)原料制成
 产品认证:欧洲CE,ROHS
 防水等级:IP68
 防火等级:UL94V-2
 颜色种类:黑色Ral9005、灰色Ral7037.
 工作温度:-40°C至85°C
 产品特性:装卸只需拨插无需工具
 备注:含螺母,不带防水垫片,需外购

Thread:Metric:PG,G Material:NYLON66
 Certificates:CE,ROHS Fireproof rate:UL94V-2
 Color:Black-B,Gray-G. Work temperature:-40°C to 85°C
 Features:Install or discharge without tools,just insert or output the conduit Remarks:Come with lock nut,but without washer, need to buy separately

Ral9005 Ral7037

单位/Unit:mm

型号 Item No.		螺纹规格	对应软管	螺纹外径	机板开孔	螺纹长度	内孔径	外径	高度	包装	
黑色 Black Ral9005	深灰色 Gray Ral7037	Thread	Tubing outer BG	Thread O.D. D1	Panel Mounting Hole	Thread Length GL	Smallest inner I Ø	Largest outer B Ø	Total length H	Std.Pkg. pcs	
公制螺纹BGQ1-M											
BGQ1-M12B (BG07)	BGQ1-M12G (BG10)	M12×1.5	BG-07	12	12-12.3	10	7	17.0	32.5	100PCS	
BGQ1-M16B (BG07)	BGQ1-M16G (BG10)	M16×1.5	BG-07	16	16-16.3	10	10	17.0	32.5		
BGQ1-M16B (BG10)	BGQ1-M16G (BG10)	M16×1.5	BG-10	16	16-16.3	10	12	20.0	32.5		
BGQ1-M16B (BG12)	BGQ1-M16G (BG12)	M16×1.5	BG-12	16	16-16.3	10	12	23.0	37.0		
BGQ1-M18B (BG10)	BGQ1-M18G (BG10)	M18×1.5	BG-10	18	18-18.3	10	10	20.0	32.5		
BGQ1-M18B (BG12)	BGQ1-M18G (BG12)	M18×1.5	BG-12	18	18-18.3	10	10	23.0	37.0		
BGQ1-M18B (BG15)	BGQ1-M18G (BG15)	M18×1.5	BG-15	18	18-18.3	11	13	25.5	40.0		
BGQ1-M20B (BG10)	BGQ1-M20G (BG10)	M20×1.5	BG-10	20	20-20.3	10	12	23.0	37.0		
BGQ1-M20B (BG12)	BGQ1-M20G (BG12)	M20×1.5	BG-12	20	20-20.3	10	12	23.0	37.0		
BGQ1-M20B (BG15)	BGQ1-M20G (BG15)	M20×1.5	BG-15	20	20-20.3	11	13	25.5	40.0		
BGQ1-M20B (BG17)	BGQ1-M20G (BG17)	M20×1.5	BG-17	20	20-20.3	12	15	29.5	43.5	50PCS	
BGQ1-M24B (BG17)	BGQ1-M24G (BG17)	M24×1.5	BG-17	24	24-24.4	12	17	29.5	43.5		
BGQ1-M25B (BG17)	BGQ1-M25G (BG17)	M25×1.5	BG-17	25	25-25.4	12	17	29.5	43.5		
BGQ1-M25B (BG23)	BGQ1-M25G (BG23)	M25×1.5	BG-23	25	25-25.4	12	20	37.0	46.0		
BGQ1-M25B (BG29)	BGQ1-M25G (BG29)	M25×1.5	BG-29	25	25-25.4	12	20	37.0	46.0		
BGQ1-M27B (BG23)	BGQ1-M27G (BG23)	M27×1.5	BG-23	27	27-27.4	12	23	37.0	46.0		
BGQ1-M30B (BG23)	BGQ1-M30G (BG23)	M30×2.0	BG-23	30	30-30.4	12	23	37.0	46.0		
BGQ1-M32B (BG23)	BGQ1-M32G (BG23)	M32×1.5	BG-23	32	32-32.4	12	30	37.0	46.0		
BGQ1-M32B (BG29)	BGQ1-M32G (BG29)	M32×1.5	BG-29	32	32-32.4	12	30	44.0	48.0		
BGQ1-M36B (BG29)	BGQ1-M36G (BG29)	M36×2.0	BG-29	36	36-36.4	12	30	44.0	48.0		
BGQ1-M40B (BG29)	BGQ1-M40G (BG29)	M40×1.5	BG-29	40	40-40.4	12	35	51.5	50.0	10PCS	
BGQ1-M40B (BG36)	BGQ1-M40G (BG36)	M40×1.5	BG-36	40	40-40.4	12	35	51.5	50.0		
BGQ1-M48B (BG36)	BGQ1-M48G (BG36)	M48×2.0	BG-36	48	48-48.4	12	35	51.5	50.0		
BGQ1-M50B (BG36)	BGQ1-M50G (BG36)	M50×1.5	BG-36	50	50-50.4	12	35	51.5	50.0		
BGQ1-M50B (BG48)	BGQ1-M50G (BG48)	M50×1.5	BG-48	50	50-50.4	12	36	51.5	50.0		
BGQ1-M56B (BG48)	BGQ1-M56G (BG48)	M56×2.0	BG-48	56	56-56.4	15	48	65.5	54.0		
BGQ1-M63B (BG48)	BGQ1-M63G (BG48)	M63×1.5	BG-48	63	63-63.4	15	48	65.5	54.0		
德制螺纹BGQ1-P											
BGQ1-PG7B(BG07)	BGQ1-PG7G(BG10)	PG7	BG-07	12.5	12.5-12.8	10	7	20.0	32.5	100PCS	
BGQ1-PG7B(BG10)	BGQ1-PG7G(BG10)	PG7	BG-10	12.5	12.5-12.8	10	7	20.0	32.5		
BGQ1-PG9B(BG10)	BGQ1-PG9G(BG10)	PG9	BG-10	15.2	15.2-15.5	10	7	20.0	32.5		
BGQ1-PG11B(BG10)	BGQ1-PG11G(BG10)	PG11	BG-10	18.6	18.6-18.9	10	7	20.0	32.5		
BGQ1-PG11B(BG12)	BGQ1-PG11G(BG12)	PG11	BG-12	18.6	18.6-18.9	10	13	23.0	37.0		
BGQ1-PG13.5B(BG10)	BGQ1-PG13.5G(BG10)	PG13.5	BG-10	20.4	20.4-20.7	10	13	20.0	32.5		
BGQ1-PG13.5B(BG12)	BGQ1-PG13.5G(BG12)	PG13.5	BG-12	20.4	20.4-20.7	10	13	23.0	37.0		
BGQ1-PG13.5B(BG15)	BGQ1-PG13.5G(BG15)	PG13.5	BG-15	20.4	20.4-20.7	11	14	25.5	40.0		
BGQ1-PG13.5B(BG17)	BGQ1-PG13.5G(BG17)	PG13.5	BG-17	20.4	20.4-20.7	12	16	29.5	43.5		
BGQ1-PG16B(BG17)	BGQ1-PG16G(BG17)	PG16	BG-17	22.5	22.5-22.8	12	16	29.5	43.5		
BGQ1-PG21B(BG23)	BGQ1-PG21G(BG23)	PG21	BG-23	28.3	28.3-28.7	12	24	37.0	46.0	50PCS	
BGQ1-PG29B(BG29)	BGQ1-PG29G(BG29)	PG29	BG-29	37.0	37.0-37.4	12	30	44.0	48.5		
BGQ1-PG36B(BG36)	BGQ1-PG36G(BG36)	PG36	BG-36	47.0	47.0-47.4	12	37	51.5	50.5		
BGQ1-PG42B(BG48)	BGQ1-PG42G(BG48)	PG42	BG-48	54.0	54.0-54.4	12	44	65.5	54.0		
BGQ1-PG48B(BG48)	BGQ1-PG48G(BG48)	PG48	BG-48	59.3	59.3-59.7	15	48	65.5	54.0		
英制螺纹BGQ1-G											
BGQ1-G3/8B(BG07)	BGQ1-G3/8G(BG07)	G3/8	BG-07	16.5	16.5	10	7	20.0	32.5		50PCS
BGQ1-G1/2B(BG12)	BGQ1-G1/2G(BG12)	G1/2	BG-12	21.3	21.3	10	13	23.0	37.0		
BGQ1-G1/2B(BG17)	BGQ1-G1/2G(BG17)	G1/2	BG-17	21.3	21.3	12	16	29.5	43.5		
BGQ1-G3/4B(BG23)	BGQ1-G3/4G(BG23)	G3/4	BG-23	26.6	26.6	12	24	37.0	46.0		
BGQ1-G1B(BG29)	BGQ1-G1G(BG29)	G1	BG-29	33.2	33.2	12	30	44.0	48.5		